

isorock® Technical data

isorock®

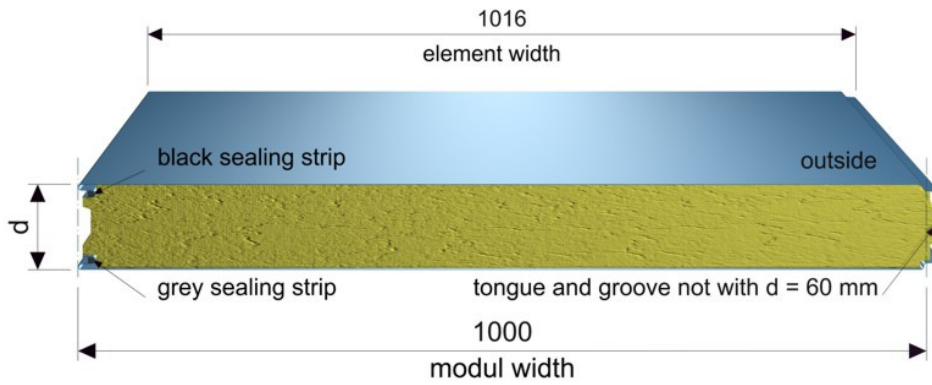

isorock®

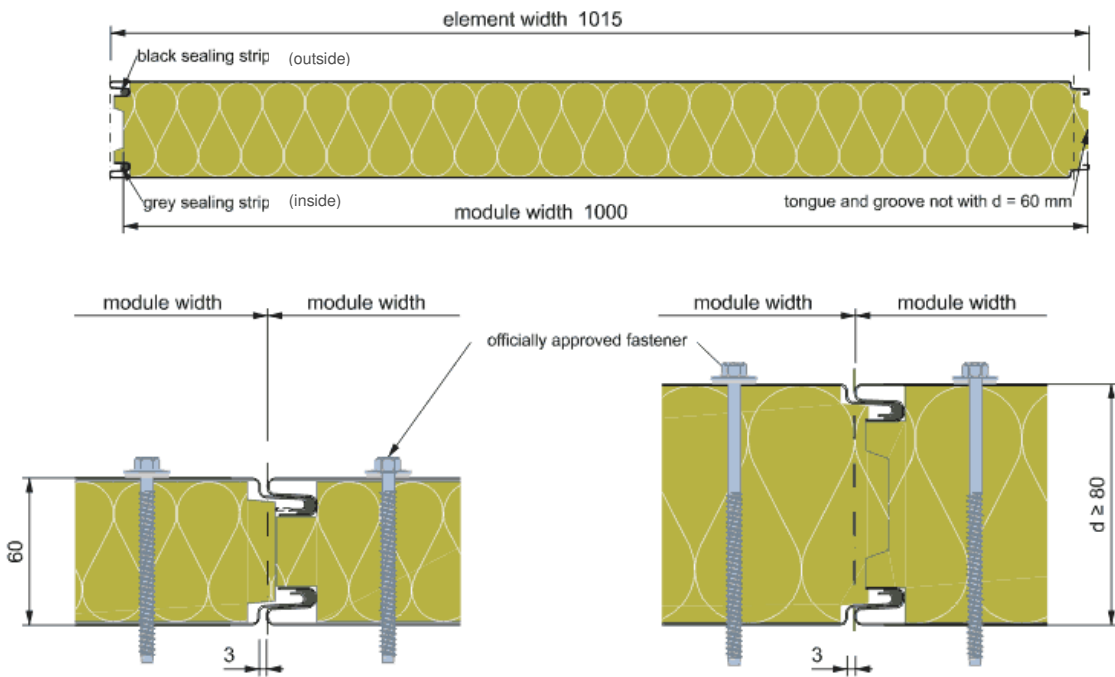

Designation of building element	Typ	Element thickness d	Material thickness		max. length supplied	weight	Thermal resistance R*	Heat transfer coefficient U*	Thermal resistance R _D **	Heat transfer coefficient U**
			Outer sheet t _N	Inner sheet t _N						
		mm	mm	mm	m	kg/m ²	m ² K/W	W/m ² K	m ² K/W	W/m ² K
Hoesch isorock®	D0	60	0,50 0,75	0,50 0,75	16,0 16,0	14,0 18,3	1,44	0,62	1,40	0,65
		80			16,0 16,0	15,8 20,1	1,93	0,48	1,90	0,50
		100			16,0 16,0	17,6 21,9	2,41	0,39	2,40	0,40
		120			16,0 16,0	19,4 23,7	2,9	0,33	2,90	0,34
		140			16,0 15,7	21,2 25,5	3,39	0,28	3,35	0,29
		160			16,0 14,7	23,0 27,3	3,88	0,25	3,85	0,25
		180			16,0 13,8	24,8 29,1	4,37	0,22	4,35	0,23
		200			15,1 13,0	26,5 30,8	4,85	0,20	4,85	0,21
Hoesch isorock®	D1	60	0,50 0,75	0,50 0,75	16,0 16,0	14,6 18,9	1,37	0,65	1,35	0,67
		80			16,0 16,0	16,6 20,9	1,84	0,50	1,80	0,52
		100			16,0 16,0	18,6 22,9	2,30	0,40	2,30	0,42
		120			16,0 16,0	20,6 24,9	2,77	0,34	2,75	0,35
		140			16,0 14,9	22,6 26,9	3,23	0,29	3,20	0,30
		160			16,0 13,9	24,6 28,9	3,70	0,26	3,70	0,27
		180			15,1 13,0	26,6 30,9	4,16	0,23	4,15	0,24
		200			14,1 12,2	28,5 32,8	4,63	0,21	4,60	0,21
Hoesch isorock®	D2	60	0,50 0,75	0,50 0,75	16,0 16,0	16,0 20,4	1,31	0,68	1,30	0,70
		80			16,0 16,0	18,5 22,9	1,76	0,52	1,75	0,54
		100			16,0 15,8	21,0 25,4	2,20	0,42	2,20	0,43
		120			16,0 14,4	23,5 27,9	2,64	0,36	2,60	0,37
		140			15,4 13,2	26,0 30,4	3,09	0,31	3,05	0,32
		160			14,0 12,2	28,5 32,9	3,53	0,27	3,50	0,28

Element thickness d=150 mm, longer versions or other combinations of material thickness on request

* calculating acc. to EN ISO 6946

** calculating acc. to EN 13162 taking account of the joints acc. to EN 14 509

fire resistance

Building material category **A2-s1, d0** to EN 13501-1
"non combustible"

Fire resistance category for use as a wall element

Fire resistance class	Laying direction	Max. spacing m	Type	Element thickness mm	P-Nr.
F30-A	vertikal	≤ 4,00	D2	≥ 60	

DIN 4102-2,3	F90-A	vertikal	≤ 5,00	D2	≥ 100	Certification no. P-3545/2430-MPA BS
			≤ 6,00	D2	≥ 120	
		horizontal	≤ 3,20	D2	≥ 100	
			≤ 6,00	D2	≥ 120	
	F120-A	vertikal	≤ 5,00	D2	≥ 120	
	W90-A	Vertikal	≤ 5,00	D2	≥ 80	Test certification P-3544/2420-MPA BS
Horizontal		≤ 4,50	D2	≥ 100		
DIN EN 13501-2*	EI 30*	See 1)	≤ 4,00	D2	≥ 60	K-3431/200/08-MPA BS
	EW *	See 1)	≤ 4,00	D2	≥ 60	K-3431/200/08-MPA BS
	EI 60*	See 1)	≤ 4,00	D1	≥ 80	9477 B
	EW 60*	See 1)	≤ 4,00	D1	≥ 80	9477 B
	EI 90*	See 1)	≤ 4,00	D1	≥ 160	PB III/B-03-036

Fire resistance category for use as a floor element

Class	Fire resistance class Condition of support / flame impingement conditions	Max. spacing ¹ m	Type	Element thickness mm	P-Nr.
DIN EN 13501-2*	EI 30**	≤ 4,40	D1	≥ 100	PB III/B-02-237
	Unsupported floor / flame impingement from below "a ← b"				

*) Test according to EN 1363-1 und EN 1364-1, Classification according to EN 13501-2

***) Test according to EN 1364-2, Classification according to EN 13501-2

1) In Germany, only vertical laying is permissible, in other countries both vertical and horizontal laying are permissible

Sound insulation

Sound reduction index RW = 29 dB.

Air permeability of joints

For horizontally and vertically laid isorock®

a = 0 m³/h m daPa_{1,0}

(as per test reports no. P6-307/1999 and no. P6-306/1999)

Material

Cover sheets:	Steel grade S 320 GD+ZA255 according to DIN 10214 alloy-galvanised GALFAN®
Insulating core:	Non-combustible mineral fibre, building material class A1 as per DIN 4102-1

Approval

General approval no. Z-10.4-235 issued by the Building Authorities

Profiling of cover shells

	Outer sheet	Inner sheet
micro-profiled	M	x
V-profiles	V	x
Slightly profiled	L	x
Flat	E	o

o = on request

Ref.no. for ordering

example: isorock® ML 80 / 0.60 - D1

isorock®	M	L	80	/	0,60	-	D1
	Outer shell type	Inner shell type	Element thickness		Thickness of cover shells		Type
	M = micro-profiled	L = slightly profiled	80 mm		0,60 mm		D1

ThyssenKrupp Bausysteme GmbH

Hammerstraße 11

57223 Kreuztal, Germany

Phone ++ 49 / 2732 / 599 – 1221

Fax ++ 49 / 2732 / 599 – 1219

e-mail export.tks-bau@thyssenkrupp.comInternet www.tks-bau.com